

Team, I have been getting many questions about the proper application of our self-contained HEPA filter solutions to combat the COVID 19 pandemic. The selections below are tagged with the appropriate option on the next page. The options are generated from the ASHE / ASHRAE 170 Technical Committee presentation issued on 3/22/2020. If there are technical questions at your hospitals or facilities and you are not comfortable advising the customer, then please provide them with this document and have them call me so I can direct them to the appropriate selection. The ASHE / ASHRAE graphics on page 2 are critical to help with the discussion

AIR BORNE VIRUS REDUCTION SOLUTIONS

- 1) Fan Filter unit 120 Volt with cradle 700 cfm – **Option 4 only**
- 2) Fan Filter unit 120 Volt with discharge plenum and discharge duct (700 cfm) – **Option 1, 2, or 3**
 - a) Available with cradle
- 3) Reverse Flow Fan Filter unit 120 Volt with ducted outlet - **Option 1, 2, or 3**
 - a) Ceiling or wall adaptor if required
- 4) CC 500 (425 to 500 cfm) 120 Volt (Must specify configuration)
 - a) Recirculation – **Option 4**
 - b) 10" outlet collar – **Option 1, 2, 3**
 - c) 10" inlet and outlet collar – **Option 2**
- 5) MAP 400 - 200 to 400 cfm 120Volt - **Option 4**
 - a) With block out kit - **Options 1,2,and 3**
- 6) MAP 800 – 400 to 800 cfm 120Volt - **Option 4**
 - a) With block out kit - **Options 1,2,3**
- 7) UVC Emitters – upper room UVC should be employed in all options

Also, please be advised that air should not be exhausted directly outside unless there is a 100% assurance it cannot be re-entrained into the facility or expose anyone outside to the exhausted air.



HEPA RECIRCULATION OPTIONS:

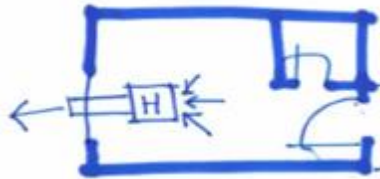

OPTION 1.

IN ROOM HEPA, DISCHARGING TO EXTERIOR
THRU A WINDOW OR OTHERWISE

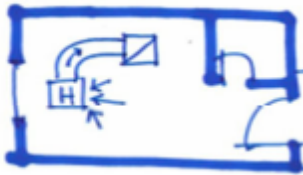

OPTION 2.

IN ROOM HEPA, DISCHARGING TO RETURN.



OPTION 3.

IN ROOM HEPA, DISCHARGING TO ADJACENT
CORRIDOR



OPTION 4.

IN ROOM HEPA, RECIRCULATES AIR IN ROOM.
SELECT FOR 12 OR HIGHER AC'S/H.

RETURNS SHOULD BE COVERED IN OPTIONS 1 AND 3. IN OPTION 4 STEPS NEED TO BE TAKEN TO PREVENT POSTIVE PRESSURE.

SOURCE: ASHRAE COVID 19 GUIDANCE issued 3/22/2020. This guidance represents the personal opinions of the ASHE /ASHRAE Standard 170 Committee